

SITE OVERVIEW
1:8,000

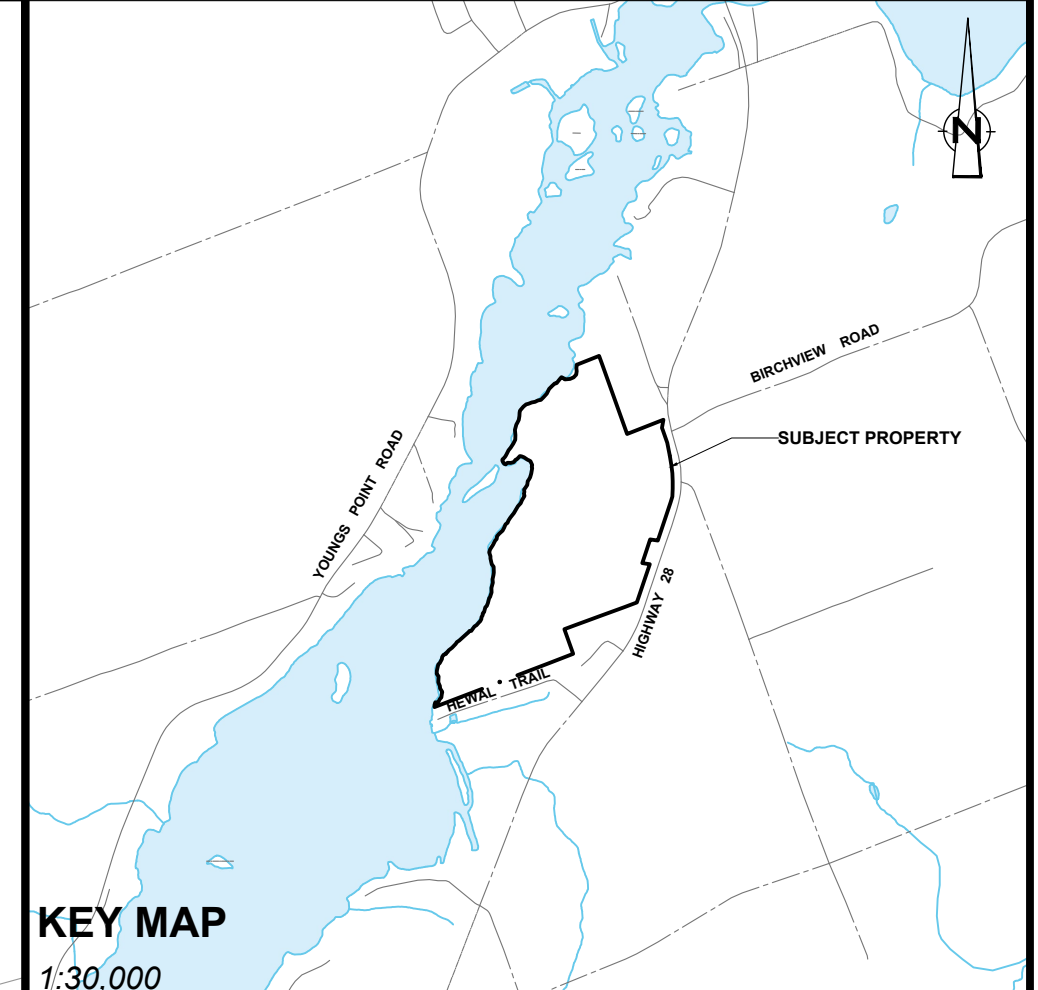

- KEY MAP**
1:30,000
- SUBJECT BOUNDARY
 - EXISTING PARCEL
 - WATERBODY
 - EX. WETLAND (FROM CAMBIUM EIS REPORT)
 - WETLAND/SHORELINE BUFFER (30m)
 - REGULATED FLOOD LINE (233.38m CONTOUR)
 - EDGE OF EXISTING WOODLAND
 - EXISTING HYDRO LINE
 - EXISTING CONTOUR LINE (0.5m INTERVAL)
 - EROSION HAZARD LIMIT (FROM CAMBIUM SLOPE STABILITY STUDY)

- NOTES:**
- PROPERTY / RIGHT-OF-WAY BOUNDARIES ARE APPROXIMATE.
 - TEMPORARY BENCHMARK: TOP OF SURVEY SPIKE SET IN THE SOUTH EASTERLY FACE OF HYDRO SERVICE POLE SERVICING THE 2 STOREY DWELLING. ELEVATION = 238.80m
 - TOPOGRAPHIC SURVEY WAS DONE BY ECOVUE CONSULTING SERVICES INC. ON JUNE 27TH, 2019.

EcoVue Consulting Services Inc.

 311 George St. N., Suite 200
 Peterborough ON K9J 3H3
 Tel: 705-876-8340 Fax: 705-742-8343
 www.ecovueconsulting.com

DRAWN BY: MC	PROJECT No.: 23-2561
APPROVED BY:	HORIZ. SCALE: 1:1250
REVISION DATE: MARCH 08, 2024	PLOT DATE: MARCH 08, 2024

NORTHCOTE FARMS
LAKEFIELD COLLEGE SCHOOL
 PART OF LOTS 23 & 24, CONCESSION 5
 GEOG. TWP. OF DOURO
 THE TOWNSHIP OF DOURO-DUMMER
 COUNTY OF PETERBOROUGH